

Mini Tornado 2050



Touchdown! The Tempest Tornado 2050 is a weather-resistant enclosure designed to provide optimum lifetime and operating conditions for smaller automated luminaires, used in exterior locations.

Tornado 2050 is a simplified enclosure, designed to maintain optimum operating conditions and equipment life for smaller automated luminaires, such as the Martin SmartMAC 150. The enclosure comprises a clear dome, in which the luminaire has complete freedom of movement, and a fiberglass base, containing ventilation and control equipment.

Tornado models have been tested and approved for many luminaire types, and the list is growing all the time. If your light is not on the list, we'll test it and approve it as part of your project.

Tornados have been running for years in deserts, through winters, and at sea - all over the world.

- | | |
|-----------------------|---|
| Enclosure | Non-corrosive fiberglass composite, stainless steel and aluminum. Acrylic optically clear 250° x 360° projection globe, 24" (610mm) diameter. |
| Luminaire Type | Up to 250W watt automated luminaires, Martin SmartMAC 150 or similar |
| Security | Three Heavy-Duty stainless steel key draw latches, 2 with secondary catch. Stainless steel eyebolt for safety bond. |

- Orientation** Normally base-down. Other orientations require minor modifications and must be advised with order.
- Finish** Urethane coating, to AAMA603-8 standard. Standard colors beige, white or gray. Custom colors to special order.
- Cooling** Filtered fresh air cooled using dual-speed DC fan, fused and polarity protected. One washable filter.
- Mounting** Two parallel 1 5/8" x 13/16" Unistrut. Mount with suitable standard Unistrut hardware, or order 4 sets per enclosure of either of the following Tempest mounting kits. Tempest kits are made from stainless steel and aluminum hardware.



4900.MB *Stainless Steel Unistrut channel nut, bolt and washer. Four required per enclosure.*



4900.MC *Stainless Steel Unistrut channel nut, bolt and pipe clamp, for pipes 1.5" (38mm) to 2" (50mm) OD. Four required per enclosure.*

- Control Wiring** DMX control cable feedthrough exterior conduit access box. Cable by others.
- Electrical** Connections landed in exterior conduit box.
 Enclosure: hardwired on site, 120V 10amps, or 230V 5amps, 50/60Hz
 Light Fixture: Americas: NEMA L6-20 receptacle provided
 Asia/Europe: CE17 16amp receptacle provided
- Ordering Information** The following information must be provided with each order:
- Luminaire type, model number and lamp power
 - Orientation (base-down, base-up, or other angle)
 - Base Color: White, Gray, Beige or Custom
 - Supply Voltage

Specification Unit shall be a Tempest Lighting Tornado 2050. The housing shall be non-corrosive fiberglass composite. Further, the unit shall possess filtered forced air ventilation in combination with heater and controlled by a microprocessor with a temperature display. Unit shall be ETL listed to U.L. standard 508 for wet locations and be a NEMA type 3R. The unit shall have above ground connection ports, compression latches with padlock rings, and may be secured to its mounting via stainless steel eye bolt, making it highly theft resistant. Unit shall provide a power cutoff to fixture in case of high temperature inside enclosure. Units shall control cool-down rate of lighting fixture by use of heater. Unit shall have a projection globe with 360° of pan and 260° of tilt. The fixture shall be identified as The Tornado Enclosure manufactured by Tempest Lighting, Inc., of North Hollywood, CA, USA.

Dimensions

25"(dia) x 35.5"(h), weight 42lb* - 635mm(dia) x 902mm(h), 19kg*

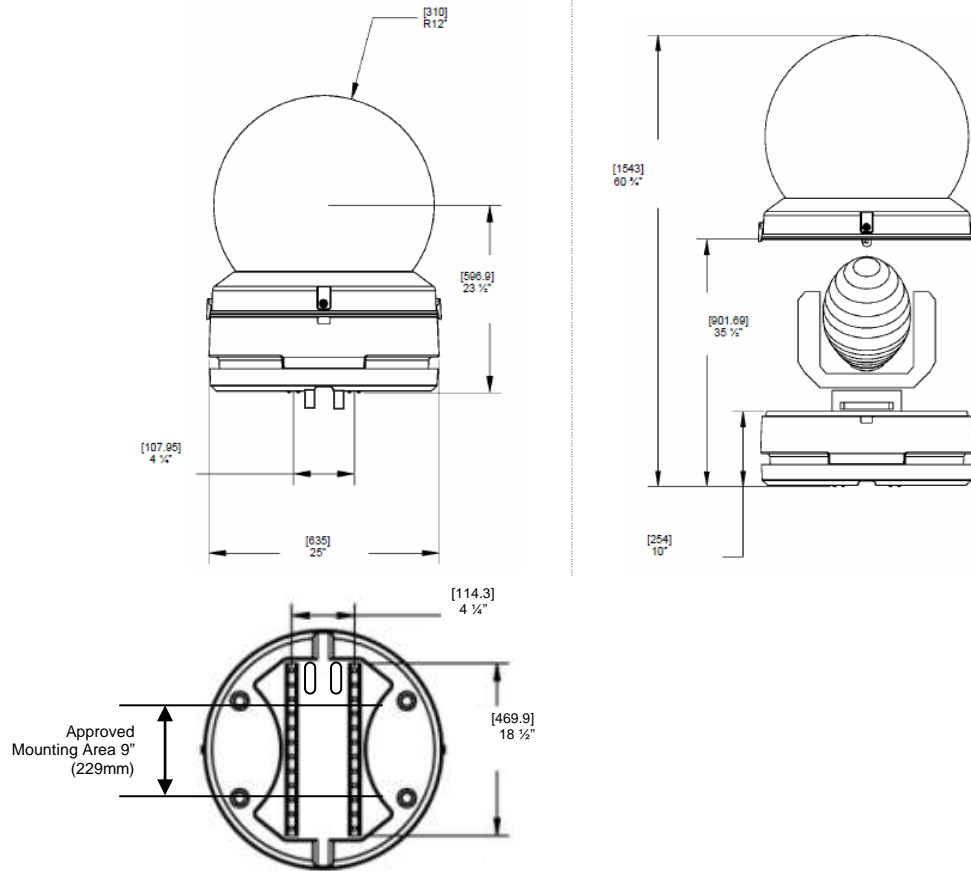

Shipping (crated)

30"x30"x46"(h), weight 112lb* - 76 x 76 x 117cm(h), 51kg*

Schedule B Export Code: 8536.30.0000

* *Weights may vary, due to fittings required for different luminaire types*

Approvals



NEMA type 3R

ETL and cETL listed to UL Standard 508 (7/11/05), CE. NEMA Type 3R.

This product is covered by US Patent Number 6,352,358.

In the interest of continuous product improvement, specifications are subject to change without notice

Tempest Lighting, Inc.,

5401 Bevis Avenue, Sherman Oaks, CA 91411, USA

www.tempestlighting.com info@tempestlighting.com

t: +1 818 787 8984

f: +1 818 787 4994

